



Company Profile 2010



Afri-Coast Engineers SA (Pty) Ltd is a wholly South African, independent and owner managed consulting engineering company, established in 1996 as Silva McGillivray Inc. with a fast growing professional team, committed to rendering a quality service, which meets the requirements of our customers and satisfies their expectations. Shareholding is 100% by the employees of the company with a 28.4% BEE shareholding.

Vision

Afri-Coast's vision is to be amongst the world's leading companies in providing sustainable consulting engineering and project management solutions.

Mission

Afri-Coast's mission is to be a world-class infrastructure consulting engineering and project management company providing a service that will add sustainable value-engineering solutions to the operation of its Clients in commerce, industry and the public sector.

Afri-Coast strives to understand its Clients needs and to deliver service excellence with uncompromising passion and quality.

Afri-Coast Engineers SA (Pty) Ltd
PO Box 5104
Walmer 6065
Port Elizabeth
South Africa

Physical Address:

Afri-Coast House
C/o Rose & Havelock Streets
Central
Port Elizabeth

Contact details:

Tel: +27 41 505 8000
Fax: +27 41 585 3437
Email: info@afriacoast.com
URL: www.afriacoast.com

MEMBER COMPANY OF THE SOUTH AFRICAN ASSOCIATION OF CONSULTING ENGINEERS,
AFFILIATED TO THE INTERNATIONAL FEDERATION OF CONSULTING ENGINEERS



Afri-Coast Engineers is committed to:

Integrity

- Uncompromising integrity in the conduct of our business through moral uprightness, honesty and open disclosure of information.

Excellence

- Delivery of service excellence with uncompromising quality and passion.

Passion and Quality

- Pursuing uncompromising quality with passion and excellence.

Employees

- Considering our employees as our most valued resource, enhancing diversity in our workforce and working in partnership to create a better future for all of our people.

Solutions Orientated

- Creative sustainable, solutions-orientated approach to all projects.

Customer Focus

- Understanding our Customers needs and gaining preferred status by delivering sustainable solutions that fulfil our customers' requirements.

Leadership

- Applying the vision, experience and energy of a strong leadership team to the pursuit of profitable growth.

Business Associates

- Fostering loyalty in our partners, suppliers, financiers and advisors.

Health, Safety & Environment

- Integrating sound health, safety and environmental management into all aspects of our business activities.

Social Responsibility

- Supporting a socially responsive, free market economy.
- Participating in the development along a sustainable growth path of the economies of all countries in which we operate.

Core Services

1 Transportation

Transportation studies and traffic engineering
Design, maintenance and rehabilitation of bridges
Bridge inspections and management systems
Pavement design
Maintenance and rehabilitation of urban and rural freeways
Road Safety assessments and audits

2 Water and Waste Water

Water resources planning and water quality analysis
Water treatment and waste water treatment design
Water Demand Management
Stormwater management
Reticulation design

3 Pipeline Services

Bulk water supply pipelines; bulk waste water mains;
Cathodic protection systems;
Pipeline corrosion investigations pumping systems designs

4 Structural Rehabilitation

Concrete Repair and Rehabilitation;
Life Cycle Costing; and modeling
Electrochemical treatment design: Chloride Extraction, re-alkalisation of Concrete; Chemical Treatment; Cathodic Protection
Building Renovation and Waterproofing Design and Rehabilitation

5 Building/Structural

Structural reporting and evaluation of alternative designs
Design of industrial, retail, residential and office buildings
Design of basement and elevated parking garages
Design of water and earth retaining structures
Design of foundations for specialist machinery
Building alterations, strengthening and extensions

6 Asset Management

Inspections and Forensic surveys and audits
Corrosion diagnostic investigations
Rehabilitation design, documentation and specification
Quality Management

7 Project Management

Contract documentation
Feasibility studies, estimating and budget control
Construction Monitoring
Quality Management auditing

8 Geographic Information Systems (GIS)

GIS user needs analysis
GIS based applications development and customization
Spatial Database Design and Management
GIS Project management, project design and implementation
Spatial Data Analysis
Map preparations service

9 Environmental Services

Environmental management services and policies
Scoping reports, strategic environmental assessments
Environmental impact assessments,
Environmental management plans

10 Coastal Engineering Field

Data collection and analysis: wind, waves, currents, water quality, bathymetry and beach surveys
Numerical modelling of coastal processes
Coastal zone monitoring and management
Design of coastal structures: coastal protection, port & harbour, amenity enhancement

11 Renewable Energy Initiatives

Wind Energy
Biogas
Landfill Gas
Solar Energy

The board of Afri-Coast comprises four executive directors: Tsepang Setipa MTech, Venance da Silva PrEng, Donald McGillivray PrEng and Dup van Renen PrEng.

Venance da Silva Pr. Eng Pr. CM

B Sc Eng (Civil) Natal University

N Dipl. EDP

MSAICE, MWISA, MCSSA, (Past President), MIMESA



Managing Director responsible for Division: Environmental and Geotechnical Engineering, Roads and Transportation with 18 years relevant experience.

- 1984-1988: Graduate Engineer: Roads and Stormwater Division, Port Elizabeth City Engineer's Department.
- 1989-1993: Assistant Water Engineer: Water Planning & Design Division, Port Elizabeth City Engineer's Department.
- 1994-1996: Head of Design Division, Port Elizabeth City Engineer's Department
- 1996-1998: Director: Silva McGillivray Incorporated Consulting Engineers.
- 1998- present: Director: Afri-Coast Engineers**

Donald McGillivray Pr Eng Pr. CPM

B Sc Eng (Civil) University of Cape Town

MSAICE, MCISA, MSISA, MWISA, MCSSA, MIMESA



Director responsible for Division: Energy, Water, Structures and Rehabilitation with 14 years relevant experience.

- 1989-1990: Graduate Engineer: Water Operations Division, Port Elizabeth City Engineer's Department.
- 1990-1993: Graduate Engineer: Water Planning & Design Division, Port Elizabeth City Engineer's Department.
- 1994-1996: Assistant Water Engineer: Water Planning & Design Division, Port Elizabeth City Engineer's Department
- 1996-1998: Director: Silva McGillivray Incorporated Consulting Engineers.
- 1998- present: Director: Afri-Coast Engineers**

Tsepang Setipa

MBA (Current) - NMMU
 M Tech Entrepreneurship - NMMU
 Post Grad Dip GIS – NMMU /UNIGIS
 N Dip (Civil) - NMMU
 O Dip (Civil) - Lesotho



MSAICE

Director responsible for Business Development, GIS, Marketing, Human Resources and Quality AND Project Management.

- Jan – Aug 1996 Trainee Technician, Lesotho Highlands Development Authority
- Sep 1996 – Sep 1997 Civil Engineering Technician, SM Consulting Engineers (Pty) Ltd (Lesotho)
- Oct – Dec 1997 Flow Testing Assistant, Lesotho Highlands Tunnel Partnership (LHTP)
- Jan 1999 – Feb 2001 Civil Engineering Technician, SM Consulting Engineers (Pty) Ltd (Lesotho)
- June – August 2001 Engineering Geology Field Assistant, Bopite Engineering Geologists (PE)
- June - Dec 2002 GIS Student Researcher, Lesotho Highlands Development Authority (LHDA)
- Jan – July 2003 GIS Manager, Africoast Engineers SA (Pty) Ltd
- Aug 2003 - present Director: Afri-Coast Engineers**

DuP van Renen Pr Eng

Hons. B Eng (Civil) Stellenbosch University

MSAICE, MWISA, MIMESA



Director responsible for Division: Water and Wastewater Infrastructure with 26 years experience in all facets of the water supply and treatment industry within local government:

- 1976 – 1981 Senior and Principal Engineer, National Department of Water Affairs and Forestry
- 1981 – 1985 Assistant Town Engineer (Water & Sewerage), Municipality of Uitenhage
- 1985 – 1998 Water Engineer (Design & Planning), Port Elizabeth Municipality
- 1998 – to present Director: Afri-Coast Engineers**

A full CV of AFRI-COAST Directors and key staff is available on request.

Quality Management Systems

Afri-Coast Engineers is committed to providing a quality service, fully meeting the requirements of our customers and satisfying their expectations.

Afri-Coast's in-house total quality management system embodies the principles of ISO 9001 and ISO 14000.

Professional Affiliations

Afri-Coast Engineers and / or professionals in the company are affiliated to the following associations, councils, institutions, etc.:

- American Concrete Institute (ACI)
- Engineering Council of South Africa (ECSA)
- Institution of Municipal Engineering of Southern Africa (IMESA)
- Institute of Marketing Management of South Africa
- Corrosion Institute of South Africa
- Consulting Engineers of South Africa (CESA)
- South African Council of Natural Scientists
- South African Institute of Electrical Engineers (SAIEE)
- South African Institution of Civil Engineers (SAICE)
- Water Institute of South Africa (WISA)
- Concrete Society of Southern Africa
- Southern Africa Road Federation (SARF)
- Federation Internationale des Ingenieurs Conseils (FIDIC)
- Committee for Spatial Information (CSI)

Employment Equity

AFRI-COAST and its employees acknowledge that past legislation and practice discriminated against people of colour, women and disabled people and places them at a disadvantage in the work environment hence our compliance with the provisions of the South African Employment Equity Act of 1998 to prevent unfair discrimination and promote affirmative action in the Company. To ensure this, Employees in AFRI-COAST are appointed only to meaningful positions, meaning positions that are necessary and make a meaningful contribution to the business objectives.

Community Social Responsibilities

AFRI-COAST is committed to a programme of community development and social upliftment within the Nelson Mandela Bay Metropolitan Area.

The Directors are since 2006 directly involved with the Uitenhage Children’s Social Welfare Organization by serving on the committees of the organization, giving managerial assistance and making monthly financial contributions towards the management of the Ikhaya Lothando Children’s Home in Uitenhage.

Afri-Coast has since 2008 become involved with the social development and upliftment of Walmer Location, Port Elizabeth. Thirty members of the Young Chiefs Football Club of Walmer, are presently benefiting from the ACE financial support to the club when its full affiliation fees with Port Elizabeth Football Association, has been sponsored by the company.

We consider our local communities as the foundation building blocks for the long term social and economic wellbeing of the Nelson Mandela Bay Metropolitan Area.

Skills & Human Resources

Afri-Coast is recognised as the employer of choice in the arena of engineering services with reference to its diverse fields of specialist services. We are currently undergoing exciting strategic transformation, which will greatly enhance our future growth prospects.

Employment opportunities are considered on merit while providing opportunities for individuals from the disadvantaged communities in South Africa. Afri-Coast Engineers supports and promotes Affirmative Action and empowerment as effectively as possible. We comply with the provisions of the South African Employment Equity Act of 1998 to prevent unfair discrimination and promote affirmative action in the Company. Afri-Coast Engineers currently (2010) employs a permanent staff of 48 of which 35.42% are female and 41.67% are historically disadvantaged individuals.

Table 1 shows the composition of the company’s human resources.

Table 1: Company Human Resources			
Staff Composition	No. Staff	No. HDI	No Women
Professional Engineers	5	0	0
Professional Technologists	2	0	0
Graduate engineers and scientists	6	0	1
Technologists	3	3	1
Technicians	11	6	3
CAD Operators	3	1	1
Student Technicians	4	4	2
Technical Support	6	2	2
Administrative Support	8	4	7
Total Staff complement (No)	48	20	17
Total Staff complement (%)	100%	41.67%	35.42%

Individual employees are encouraged to take responsibility for their own development, with the Company providing appropriate resources and support for employees with the need and potential for development, where such development is mutually beneficial to both the Company and individual. Employees are trained or developed to perform their current jobs effectively before being considered for advancement.

We have developed a systematic approach aimed at constantly improving technical, managerial and administrative competence, as well as transferring company ownership and control to Historically Disadvantaged Individuals. This initiative has created a pool of highly skilled engineers, technologists and technicians within the company. Joint consultation between management and staff has led to continuous cost reduction and improved performance, service excellence, quality, safety and staff morale.

BEE Certification

Afri-Coast Engineers received BEE Verification based on the Gazetted Construction Sector Charter from BEE BIZ Compliance (Pty) Ltd and achieved a ***BEE Level 4***.

Awards

During 2009 Afri-Coast Engineers undertook a “Go Green” campaign to improve awareness and involvement in environmental projects in and around the NMBM area. To show commitment to sustainability at office level, the company decided on a green policy. At this time the environmental division was added to the staff component and a sustainability policy drawn up using their knowledge and expertise.

The result of these efforts by the directors and staff were awarded with the NMMU Geo-Sciences Award for progress in Environmental Management (Small Business).

Company Ownership

Afri-Coast Engineers is a Black Economic Empowered company and has restructured its business in line with its employment equity principles to transfer ownership of 28.17% equity of its business to full-time previously disadvantaged employees with effect from 1 August 2002. This has resulted in key technical and administrative staff having shareholding in the enterprise.

COMPANY OWNERSHIP			
NAME	DATE OF OWNERSHIP	% SHARES	HDI
Mr. Donald McGillivray	August 2002	17.8%	NO
Mr. Dup van Renen	August 2002	17.8%	NO
Mr. Venance da Silva	August 2002	17.8%	NO
Mr. Tsepang Setipa	May 2003	17.4%	YES
Me Vinmala Naik	Nov 2007	5.5%	YES
Mr. Mike Hammond	August 2002	13.2%	NO
Mr Cwenga Stinte	Nov 2007	5.5%	YES
Mr G van der Merwe	Nov 2007	5.0%	NO

**Coega IDZ Potable Water and Return Effluent Supply:
Engineering Outline Design and Performance
Specifications**

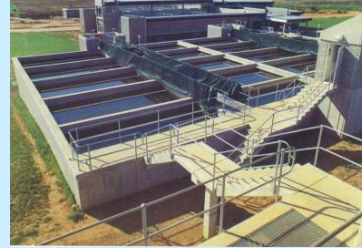

The Coega Development Corporation commissioned ACE in 1999 and 2000 to undertake the detailed engineering studies for the future potable water and return effluent supply to the Coega Industrial Development Zone for the proposed Coega IDZ.

This Stage of the infrastructure development programme involved various tertiary treatment process selections, pipeline route selection, detailed planning of infrastructure, environmental scoping and costing of alternative schemes associated with the phased development of the Coega IDZ.

Environmental scoping was carried out to assess the environmental impact and environmental mitigating factors to be implemented in the construction environmental management plan.

The engineering outline design and performance specifications were carried out for a return effluent supply scheme of 45 Ml/d capacity (Estimated Project Cost – R 65 million) for industrial consumption, firefighting and landscaping. The design study involved carrying out pilot scale trials to a stream of secondary treated domestic effluent, treatment process selection, process design and optimization and sizing of the return effluent scheme, pumped storage supply and tertiary reticulation.

The feasibility studies for return effluent treatment were followed by detailed engineering studies,, outline design and performance specifications for the tertiary treatment processes.

Farm Florida Development

Portion 10 of the Farm Florida Erf 321 in the division of Uitenhage

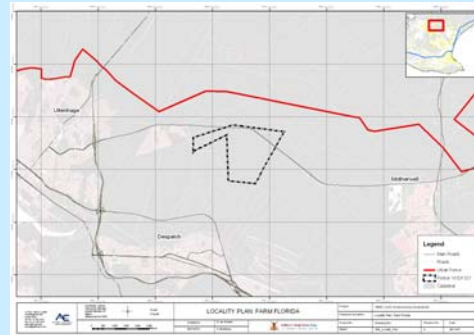

The proposed development lies within 10km of the Coega Industrial Development Zone and will assist to meet the current NMBM backlog of approximately 80 000 low income units in the metro as well as the growing demand for integrated housing within the metro.

Grupo Antolin Warehouse

Port Elizabeth



The project entailed the construction of a fully serviced 4500 square metre steel framed factory building and office block. The design, contract administration and construction monitoring of all the structural elements, earthworks, roads and civil services were the responsibility of Afri-Coast Engineers. The project was completed successfully and to a high standard.

Kouga Wind Farm



This project entailed the development and construction of 50 to 150 wind tower generators (WTG) generating between 1.8MW and 3MW each, with a hub height of about 100m and rotor blade radii of about 50m. Afri-coast installed a 40 m wind mast in 2007 close to Jeffries Bay to gather data of the area. Afri-Coast installed a 70m wind measuring mast on site in January 2010 and is gathering site specific wind data since then. The EIA (Environmental Impact Assessment) for the wind farm started in June 2009 and a Record of Decision is expected towards the end of 2010. Afri-Coast Engineering own 50% of the company developing the wind farm. Afri-Coast will also be responsible for all civil and electrical works to complete the project.

Electrawinds First Wind Tower Generator (WTG) in Coega IDZ, Zone 9, Port Elizabeth



This project entailed the construction of a Vestas V90 1,8MW wind tower generator (WTG) with a hub height of 95m and rotor blade radius of 49m. An octagon shaped concrete base of approximately 18m diameter was constructed. This WTG is the first IPP wind energy source in South Africa and Sub-Sahara Africa and is the largest WTG on the African continent. This WTG is the first of 25 WTG that will be constructed in the Coega IDZ Development Zones, north of Port Elizabeth, close to the new Ngqura deep water Harbour.

Parliament Street Environmental Upgrade



The scope of services included the design, contract documentation and construction monitoring for the engineering and landscaping services for the Environmental Upgrading of Parliament Street in the Port Elizabeth CBD and incorporated, *inter alia*, the following aspects:

- Partial pedestrianisation of Parliament Street;
- New paving, lighting, street furniture and landscaping;
- Resurfacing of the travelled way;
- Storm water management; and
- Off-loading, parking and traffic circulation requirements

Govan Mbeki Avenue Environmental Upgrade



The scope of services includes the design, contract documentation and construction monitoring for the engineering and landscaping services for the Environmental Upgrading of Govan Mbeki Avenue Phase 2 (GMA2) in the Port Elizabeth CBD and incorporates, *inter alia*, the following aspects:

- Partial pedestrianisation of Govan Mbeki Avenue and its side streets;
- New paving, lighting, street furniture and landscaping;
- Storm water management;
- Facilities for hawkers;
- Public toilet facilities;

- Provision of a subway linkage to the new transport interchange at Brister House;
- New parking areas off Chapel Street, and the upgrading of Chapel Street, west of Donkin Street, and;
- Off-loading, parking and traffic circulation requirements.

**Concrete Spalling on the South Campus,
Nelson Mandela Metropolitan University**



The contract consisted of varying degrees of rehabilitation for the buildings mentioned below. In general the buildings were constructed between 1970 - 1974 and exhibit a range of defects and problems. Some of the problems are:

- Cracking and spalling of concrete
- Deterioration of expansion joints
- Deterioration of the concrete parapets due to corrosion.
- Structural damage due to deterioration of expansion joints

Phase 1: Pedestrian Bridge Next to Music Building
Music Building
Administration Building (Ground Floor Main Columns)

Phase 2: Library Building

14. Schedule of Selected Projects

14.1 Transportation

Date	Project	Nature of work	Client	Contract Value
2008 - current	Trunk Road 45 Section 2: Rehabilitation and widening of the Bushmans (no.1 & 2), Kariega and Kasouga River bridges	Design, specify & manage rehab & widening of 2 bridges on river crossings Kariega and Kasouga River	East Cape Provincial Department of Roads	R70 m
2007 - current	Kempston Road Widening & upgrade	JV Project: Plan & design widening, s/water, relocation of services, traffic accommodation	Nelson Mandela Bay Municipality	R 50m
2009 – current	Bridge rehabilitation work on M4 Settlers Freeway : Mount Road Interchange (Phase 1 to 2)	Investigation, design & manage rehabilitation of bridge at the M4 Mount Road Interchange	Nelson Mandela Bay Municipality	R43m
2001 - 2006	N2 Section 11: Rehabilitation of Burman Road Interchange	Investigation, design & specify rehabilitation of Bridges at the N2 Burman Interchange, Port Elizabeth	South African National Roads Agency	R 40 m

14.2 Water and Waste Water

Date	Project	Nature of work	Client	Contract Value
2006 – current	Nooitgedagt Low Level Scheme	Lead consultant and project manager, and consultant for R620m x 90Ml/d additional water supply scheme to metro	Nelson Mandela Metropolitan Municipality	
2002 - current	Upgrade of Loerie water treatment works	Upgrade of 100 Ml/d water treatment plant sand filters, clarifiers and chemical dosing facilities	Nelson Mandela Metropolitan Municipality	R 20 m
2004 and current	Woodifields Development, George	Water resources analysis and masterplan including feasibility study of sea water desalination scheme for residential and agricultural development	Map of Africa Development Company (Pty)Ltd	R 400 m
2006 - current	Markman Sewer	Replacement of the 600mm diameter sewer across the Swartkops river bridge in PE	Nelson Mandela Metropolitan Municipality	R 8 m

14.3 Structural Rehabilitation and Diagnostic Investigation

Date	Project	Nature of work	Client	Contract Value
June 2006 – Dec 2007	Settlers Way: Repairs to Darling and Boswell street bridges	Concrete rehabilitation and structural strengthening	NMMM	R2,2m
1997	Fish Water Flats Water Reclamation Works: Corrosion Failure Investigation and Report	Investigation and Report	Port Elizabeth Municipality	R 100 000

14.4 Building/Structural

Date	Project	Nature of work	Client	Contract Value
2008 – Current	Grupo Antolin Factory and Warehouse	Design and contract administration for construction of factory and offices in the Nelson Mandela Bay Logistics Park The building is in excess of 1850m ² and is made up of a factory of about 4700m ² and offices, ablutions, change rooms and service buildings of about 400m ² . The building occupies a site of 9283m ² inclusive of the logistics yard.	Coega Development Corporation	R28,0 m
July 2006 - Current	Clover: Port Elizabeth: New Production Facility	Design of new structural steel buildings, reinforced concrete silo plinths, tanker hardstands, office block, walkways and miscellaneous works	Clover SA	R9m
Aug 2003 – Current	Coegakop First 17MI reservoir	Design, and construction management for construction of the proposed first 17MI potable water reservoir	Nelson Mandela Metropolitan Municipality	R 18m

14.5 Asset management

Date	Project	Nature of Work	Client	Contract Value
2006	Asset Maintenance Backlog Study	Compilation of database, development of ranking criteria, inspections & data capturing of water & sewerage infrastructure	Nelson Mandela Bay Municipality	R 1.2m
2002	Inspections to canals and siphons and asset management condition inventory report	Inspections to canals and siphons and asset management condition inventory report	Gamtoos Irrigation Board	R 100 000
1997-2006	University of Port Elizabeth, Buildings Asset Management	Inspections, diagnostic investigations and remedial works design and implementation	University of Port Elizabeth	R 23 million

14.6 Housing and Property Development

Date	Project	Nature of Work	Client	Contract Value
June 2004 - current	Ingleside Eco Lifestyle Development	Property development in Colchester (PE) along the Sundays river	International Real Estate Appraisal (IREA)	R 100m
January 2004 – current	Woodfieds Development, George	Mixed-land use development	Map of Africa development Company (Pty)Ltd	R2 billion
2003 - 2004	Willowmore Low cost Housing Project	Affordable - Cost Housing and Services Design	Imbewu Projects Services	R 6.9 m
2003 - 2004	Kenton – on Sea Low Cost Housing Project	Affordable - Cost Housing Design	Imbewu Projects Services	R 6.3 m
2003 – 2004	Station Hill Low-Cost Housing Project	Affordable - Cost Housing and Services Design	Imbewu Projects Services	R 2.1 m

14.7 Project Management, Feasibility studies and Business plans

Date	Project	Nature of Work	Client	Contract Value
2007 – Current	Farm Florida Development	Desktop prefeasibility / due diligence investigation for the provision of bulk engineering services for the proposed Integrated Housing Development.	Shelf Zone 120 (Pty) Ltd	
May 2004	N2 Street lighting	Project management and design of the implementation of the N2 street lighting between Blue water bay and Linton Grange.	Nelson Mandela Metropolitan Municipality	R 1m
May 2004	Business plan: Gateways & Beautification for DEAT poverty relief application	Implementation of the project business plan to assist the client in applying for DEAT poverty alleviation funding.	Nelson Mandela Metropolitan Municipality	Time based Fees
March 2004	New Brighton Renaissance art park	Feasibility study and business plan	Nelson Mandela Metropolitan Municipality	R120, 000
March 2004	St Georges Park Fence investigation	Investigation of the compliance to engineering standards of the St Georges Park fence design	Nelson Mandela Metropolitan Municipality	Time based fees
February 2004	Humewood Car Park	Feasibility and design of the Humewood car park	Nelson Mandela Metropolitan Municipality	Time based Fees

14.8 Urban Development and Urban Renewal

Date	Project	Nature of Work	Client	Contract Value
July 2005 - Current	Vision 2020 Beachfront Developments Projects	Planning, design, Project Management and implementation of various beachfront development projects for the Nelson Mandela Metropolitan Municipality	Nelson Mandela Bay Municipality	R 400m
April 2004	N2 Beautification Colchester - Van stadens	Beatification of the N2 between Colchester and Van stadens	Nelson Mandela Metropolitan Municipality	R 5m
Jan 2004	Integrated Beachfront Development Plan	Development of integrated beachfront integrated plan	Nelson Mandela Metropolitan Municipality	R 500,000
June 2003 - Current	Beautification of Uitenhage	Beautification of Uitenhage	Nelson Mandela Metropolitan Municipality	R 80 m
August 2003 - Current	PE Gateways and Beautification Implementation N2	Beautification Implementation N2 between Bluewater Bay and Coega in Port Elizabeth	Nelson Mandela Metropolitan Municipality	R 3 m
Jan 2003	PE Gateways and Beautification	Development of Business Plan (Application for funding from DEAT) for Beautification of major routes and entrances to Nelson Mandela Metropolitan	Nelson Mandela Metropolitan Municipality	R 90 m

14.9 Geographical Information Systems (GIS)

Date	Project	Nature of Work	Client	Contract Value
2010	Development of a health care database for PHC in NMBM	Creation of a comprehensive database of NPOs in the NMBM area with the metro clinics buffer showing their type and work description. The clinic buffer is analysed to see location of the formal health facility in the ward area. This included a media component where all awareness data was produced.	Nelson Mandela Metropolitan Municipality Dr Hoosain	R508 000
2009	Tourism feasibility study - EL and surrounds	Analysis for development of the coastal zones with regard to development and growth. Specifically looking at tourism capacity and scope for improvement thereby giving recommendations	Mr Mbeko - DEAT	R120 670
2009	Engineering infrastructure archiving	Plans were scanned in from the NMBM plan cabinets, in paper based form, then the scan was linked to the area on which the feature appeared. Eg Reservoir sites had the pipeline shown etc	Nelson Mandela Metropolitan Municipality Arwen Oberholtzer	R716 677
2008	Helenvale Status Quo	Locating and commenting on all infrastructural features that appear in the Helenvale Area. This was to deduce what was needed on urgency level for repair and rebuild	Debbie Hendricks	R500 000
2008	Update and verify services in the NMBM area in GIS format	Spatially locate all the tourism facilities in the NMBM area for analysis of operation and location on the website for 2010	Phrosne Phillips - Nelson Mandela Bay Tourism	R99 000

14.10 Electricity and Energy Projects

Date	Project	Nature of Work	Client	Contract Value
2009 – Current	Electrawinds First Wind Tower Generator (WTG) in Coega IDZ, Zone 9, Port Elizabeth	Civil and electrical engineering, including project management of the construction of a Vestas V90 1,8MW wind tower generator (WTG) with a hub height of 95m and rotor diameter of 90m.	Electrawinds - Africa and Indian Ocean Islands	R50m Est.
Dec 2009	NMB Energy Efficiency Projects	Project manage energy efficiency projects for the NMB Electricity and Energy Department	NMB Electricity: Peter Neilson	R129 million
2009 - Current	Kouga Wind Farm	Planning, design, Project Management and implementation of the development phase of the 50 to 150 turbine wind farm. The turbines will be between 1.8 to 3 MW with a hub height of 80 to 100m and a rotor blade diameter of 80 to 100m.	Red Cap / Afri-Coast Venture	R4.8billion Est.
2005 - Current	Demand Side Management	Assisting NMBM on various renewable energy projects, including the CFL rollout, DORA project for energy efficient streetlights, Fishwater Flats WWT energy efficiency, water pump stations at Nooitgedagt Low Level Scheme	NMBM	R111 m
2004 – Current	25 MW Wind Farm in Nelson Mandela Bay	Planning, design, Project Management and implementation of development phase of the 25 MW wind farm. The turbines will be between 1.8 to 3 MW with a hub height of 80m and a rotor blade diameter of 80 to 100m.	CEF / ETA Energy	R480m Est.
May 2008	Enkuselweni Place of Safety	Electrical and Electronic Services for Building Project	Department of Public Works	R2 million
Dec 2009	Nooitgedagt Water Treatment Works: Electrical	Electrical Installation forming part of upgrade of water treatment plant	NMB Municipality	R1 million

14.11 Coastal Environmental Projects

Date	Project	Nature of work	Client	Contract Value
May 2010	Establishment of Coastal Development Set-Back Lines for NMBM	Afri-Coast Engineers were appointed by the NMBM to actively determine coastal development setback lines for the Nelson Mandela Bay Municipality, in accordance with the Integrated Coastal Management Act of 2009. This study included: analysis of wave statistics, aerial photography analysis, modelling wave runup and modelling of shoreline regression due to sea level rise. Environmental and social buffering was also conducted before economic requirements were considered. The resulting setback lines will become critical planning tools for the municipality and environmental authorities alike.	Environmental Management NMBM, Mr Jerom Mkosana	R 585 000 R 359 328
	Coastal Protection using Sand Filled Geocontainers	Afri-Coast Engineers were contracted by NMBM to provide design and engineering guidance for the construction of sand filled geo-textile container revetments at Pollok Beach	NMBM, Godfrey Murrel	R300 000
Sept 2009	Beach Profile Surveys at the Port of Ngqura	Afri-Coast Engineers were contracted by Transnet National Ports Authority to conduct quarterly beach profile surveys in order to assess the impact of the newly constructed deep water port of Ngqura on littoral sediment transport and the effectiveness of the sand bypass scheme.	Transnet National Ports Authority, Elliot Matsoahole	R 43 776

14.12 Environmental Projects

Date	Project	Nature of work	Client	Contract Value
Nov 2009	North End Lake Bioremediation	The location of the 2010 FIFA Stadium adjacent to the North End Lake stimulated public interest towards the improvement of the Lake and its precincts. Afri-Coast Engineers was tasked to investigate and manage the Lake water quality improvement. Following the outcome of the investigations, which revealed high coliform levels in the Lake, Afri-Coast recommended that: the sources of pollution be addressed and in lake treatment be undertaken using environmentally sensitive options such as the construction of artificial reed beds and the use of Effective Microbes (EM) Activated Solution to reduce the biological contamination in the Lake.	NMBM – Wastewater Conveyance Directorate, Amsha Muthayan	R 1, 001, 762
July 2009	Climate Change Strategy for NMBM	Afri-Coast Engineers were appointed by NMBM to act as a lead consultant, providing planning and coordination for the roll-out of climate change strategy and response plans for the Nelson Mandela Bay Municipality. Baseline studies include: Greenhouse Gas Emissions Inventory, Integrated Resource Utilisation Audit, Long Term Scenario Projection, Vulnerability, Mitigation and Adaption Assessment. Development of NMBM Climate Change and Resource Strategy. Mitigation and Adaption Plans. Education and Awareness programs.	NMBM, Public Health, Joram Mkosana, Director (Environmental Management)	R 7, 400,000
June 2009	Upgrade of Pollock Beach Parking	The Pollock Beach Parking Upgrade is part of the integrated Beachfront Development Plan launched by the Nelson Mandela Bay Municipality (NMBM) in 2004. The incorrect location of the parking facility in the dune ridge off Scarborough and Bude Streets constantly interfered with the proper functioning of the dune, which frequently resulted in sand flooding the parking facility. The activity involved the decommissioning and removal of the old parking and creating a new parking lot landward of the dune ridge. Dune stabilisation and rehabilitation was also conducted as part of the project. Afri-Coast Engineers Environmental Team also conducted environmental control duties for the duration of this project.	NMBM, Parks , Rob Howlett, Deputy Director	NA
2007	Humpback Dolphin Trail	Afri-Coast Engineers designed and managed construction of a timber plastic walkway extending 2 km along the coastal dunes and through public open space . This walkway offers wonderful amenity to locals and tourists alike while protecting the sensitive foredune environment from excessive trampling. Africoast Engineers Environmental Team also handled the environmental control duties during construction.	Parks Department, NMBM, Rob Howlett, Deputy Director	R 6, 000, 000

15. Client and Professional References

Company: Coega Development Corporation (CDC)
Contact Person: Dr. Peter Inman
Position: Senior Technical Specialist
Telephone: +27(0) 41 507 9111
Facsimile: +27(0) 41 585 5445
Email: peterinman@coega.co.za

Company: South African National Roads Agency (SANRAL)
Contact Person: Wayne Petersen
Position: Regional Manager
Telephone: +27 (0) 41 398 3200
Facsimile: 27 041 398 3211
Email: petersenw@nra.co.za

Company: Nelson Mandela Metropolitan University
Contact Person: Stuart Blignaut
Position: Head Technical Services
Telephone: +27 (0) 41 504 2474
Facsimile: + 27 (0) 41 504 2390
Email: tecspb@upe.ac.za

Company: Nelson Mandela Metropolitan Municipality
Contact Person: Ali Said
Position: Business Unit Manager: Infrastructure and Engineering
Telephone: +27 (0) 41 506 2911

Company: Electrawinds BV
Contact Person: Tijmen Keesmaat
Position: Project Manager: Business Development Africa
Telephone: +31(0)6 431 44 261
Email: tijmen.keesmaat@electrawinds.be